

Verieri 9.63D+

Z KINEMATICS



DIESEL ENGINE

4 in-line cylinders, supercharged, charge air cooling, electronically controlled, common-rail injection, exhaust gas recirculation, water cooling, dry filtration, oxidation catalyst (DOC) particulate filter (DPF) and selective catalytic reduction (SCR). Issued according to EC Directive 97/68 - Stage V/Tier 4f.

Type	Deutz TCD 3.6 L4
Max. power	105 kW - 143 HP
Calibration (RPM)	2.300
ISO/TR 14396 power	100 kW - 136 HP
EEC 80/1269 power	100 kW - 136 HP
Maximum torque	lbf ft 369
Bore	in 3.86
Stroke	in 4.72
Displacement	in³ 220.91



ELECTRIC SYSTEM

Battery	12 Volt
Capacity	110 Ah - 850 A
Alternator	95 A
Reverse gear alarm	Standard
Cabling compliant with regulations	IP 67 - DIN 40050



TRANSMISSION

Hydrostatic with electronic power regulation and closed circuit with variable displacement pump and motor.

4 driving modes: Automotive, Work, Eco and Smart Forward Motion*. 2-speed mechanical gearbox with mechanical speed ratio variation (Shift On Fly).

2 Work Speeds	Forward	Reverse
1 st gear mph	0 ÷ 4	0 ÷ 4
2 nd gear mph	0 ÷ 10	0 ÷ 10

2 Transfer Speeds	Forward	Reverse
1 st gear mph	0 ÷ 9	0 ÷ 9
2 nd gear mph	0 ÷ 25**	0 ÷ 25**

* Optional, on request. ** Self-limited maximum speed



AXLES

Heavy Duty axles of the same size with epicyclic final reduction gears on each wheel. Rigid front axle.

Oscillating rear axle with 25° travel.

Distribution of the movement to the two front and rear axles by means of cardan shafts. Automatic self-locking differential on the front axle (optional on the rear).



BRAKING SYSTEM

Service brake: hydraulic multi-disc oil bath on front & rear axles. Parking brake: negative hydraulic, electrically operated, on the front axle.



TIRES

Standard	600/65 R25
----------	------------



STEERING SYSTEM

Power assisted steering by LOAD SENSING power steering.

Steering angle	80°
Tire inner turning radius	ft in 8'11.6"
Tire outer turning radius	ft in 16'1.23"
Bucket outer turning radius*	ft in 17'8.83"

* in transfer position



HYDRAULIC SYSTEM

Comprising two gear pumps, the first for the loader and steering circuit with LOAD SENSING valve, the second for the fan circuit, having a double rotation speed

Modular 2-section distributor with general valve.

Double acting jacks. Hydraulic oil cooling radiator.

Full-flow filter on the return circuit.

Single lever servo control for 4-position lifting control and 3-position bucket control.

Max flow rate	gpm 40.95
Loader calibration pressure	psi 3,336
Steering calibration pressure	psi 2,538
Lifting jacks	in 3.94x32.09
Bucket jacks	in 4.72x14.96
Lifting time (full)	s 4.6
Lowering time (empty)	s 3.5
Unloading time	s 1.8
Total cycle time	s 9.9



FLUIDS & LUBRICANTS

Engine	gal 2.11
Front differential	gal 4.65
Rear differential	gal 3.14
Reduction gear/adaptor	gal 0.48
Hydraulic circuit	gal 33.81
Brake circuit	gal 0.29
Fuel	gal 40.95
Water radiator	gal 5.28
AdBlue	gal 5.28



TECHNICAL FEATURES

Standard bucket capacity	yd³ 2.35
Bucket width	ft in 7'8.52"
Static tipping load on a horizontal surface	lb 13,669
Static tipping load turned 40°	lb 12,125
Hydraulic lifting capacity at max. height	lb 15,212
Hinge pin height	ft in 12'1.67"
Dump height at 40°	ft in 9'6.17"
Dump distance at 40°	ft in 2'8.09"
Breakout force	lb 18,960



DIMENSIONS & WEIGHTS

Max length in transfer position	ft in 20'0.16"
Max. width in transfer position	ft in 7'8.52"
Tire outer width	ft in 7'2.42"
Tread width	ft in 5'8.9"
Pitch	ft in 8'7.74"
Clear span	in 14.96
Max height	ft in 9'9.32"
Standard operating weight	lb 19,842
Maximum permissible weight	lb 25,000

dB NOISE LEVEL

Noise level inside cabin ISO 6396 - LpA	dB(A) 69
External noise level ISO 6395 - LwA	dB(A) 99

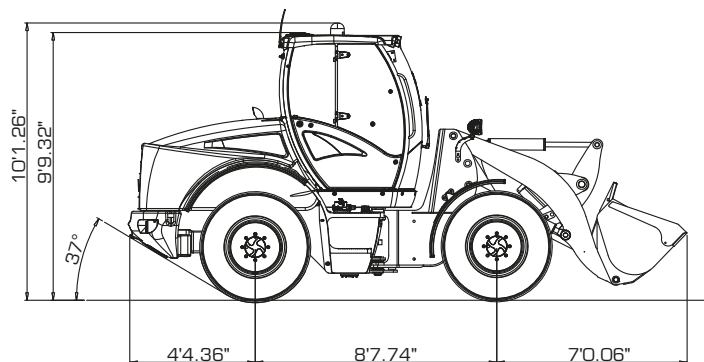
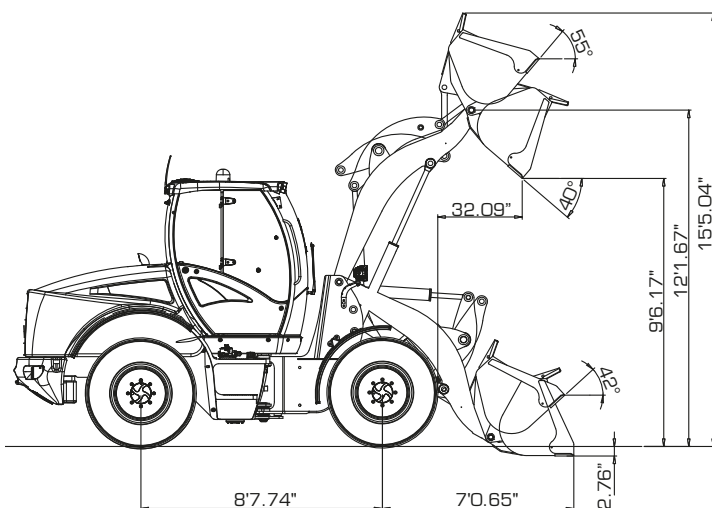

PERFORMANCE DATA

STANDARD

MULTIPURPOSE

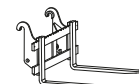
OVERSIZE

FORKS

Heaped Bucket Capacity (SAE)	yd ³	2.35	1.7	2.88	/
Bucket width	ft in	7'8.52"	7'8.52"	8'2.43"	/
Bucket weight	lb	1,433	1,653	1,653	/
Max operating height	ft in	15'5.04"	15'2.91"	15'8.82"	/
Fork length (standard)	ft in				3'3.37"
Fork length (optional)	ft in				4'3.18"
Hinge pin height	ft in	12'1.67"	12'1.67"	12'1.67"	/
Dump angle	°	40°	40°	40°	/
Dump height	ft in	9'6.17"	9'8.14"	9'3.54"	/
Dump distance	ft in	2'8.09"	2'7.5"	3'0.38"	/
Static tipping load on a horizontal surface	lb	13,669	13,889	13,228	/
Static tipping load - mach. turned	lb	12,125	12,346	11,684	/
Fork tipping load - mach. turned	lb				10,141
Operating load EN 474-3 (80%) [•]	lb				8,113
Operating load EN 474-3 (60%) [•]	lb				6,085
Breakout force	lb	18,960	21,164	17,196	/
Max length in transfer position	ft in	20'0.16"	19'9.99"	20'3.11"	/
Bucket outer turning radius	ft in	17'8.83"	17'7.85"	18'1.76"	/
Standard operating weight	lb	19,842	20,062	20,062	/

[•] Load center at 19.69"



MOST COMMON OPTIONAL TIRES | OTHER TIRES UPON REQUEST

**500/70 R24
MICHELIN XCML**

Long-life agricultural tire with high traction and high load capacity.

Machine width:
ft in 7'8.56"

**15,5 R25
MICHELIN XTLA**

High traction multi-purpose L2 tire.

Machine width:
ft in 7'2.97"

**15,5 x 25 CAMSO
LOADMASTER L3**

Optimized for multi-surface; high resistance to lateral impact and improved stability.

Machine width:
ft in 6'11.74"

**17,5 R25 AEOLUS
A2233 L5**

L5 tire with compound resistant to cut and impact. Very low puncture risk. Tread designed for exceptional traction and stability.

Machine width:
ft in 7'2.81"

**17,5 R25 MICHELIN
XMINE D2 L5**

Ideal tire for heavy loads, high strength and excellent traction/adhesion compromise.

Machine width:
ft in 7'4.19"

**17,5 R25
NOKIAN GRS**

All-season tire, ideal for winter conditions. Good driving comfort.

Machine width:
ft in 7'2.54"